

## Conveyor Technical specifications

### Conveyor

<b>Weight :</b>	3,9 kg / 8,59 lbs
<b>Maximum load :</b>	5 kg / 11 lbs
<b>Belt size :</b>	700 x 110 mm / 27,55 x 4,33 In
<b>Size :</b>	716 x 264 x 76,6 mm / 28,18 x 10,39 x 3 In
<b>Movement direction :</b>	Bidirectional
<b>Maximum speed :</b>	40 mm/s
<b>Power supply :</b>	12V - 3A
<b>SnapLink :</b>	Supported on 2 sides
<b>Robot compatibility :</b>	Ned 2
<b>Control parameters :</b>	Speed (0-100%) & direction
<b>Control option :</b>	With a compatible robot without power supply or with the external control box and power supply
<b>Noise:</b>	Less than 70dB
<b>Power consumption:</b>	Maximum power consumption in standard use 30 W Average consumption in standard use 20 W
<b>Cable :</b>	Cable between conveyor and robot (1 m / 3.28 ft) Cable between conveyor and control box (0.45 m / 1.47 ft)
<b>Temperature :</b>	The conveyor can work in a temperature range of 5 - 45°C
<b>Materials :</b>	Aluminum, PVC

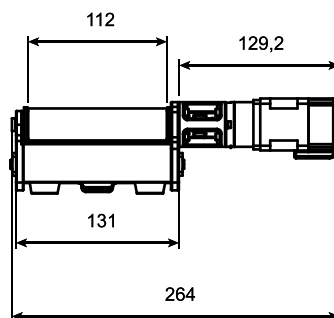
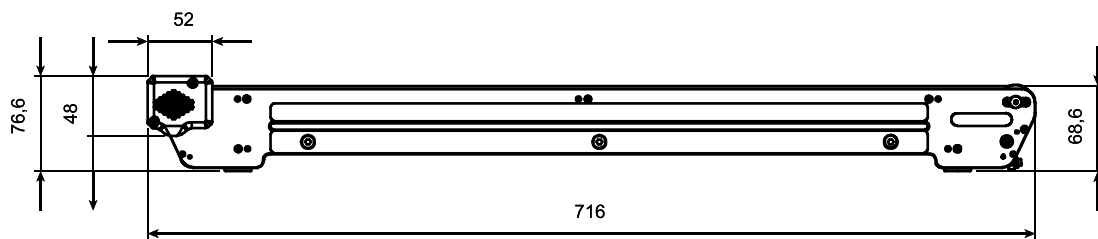

## Conveyor Technical specifications

### Control box

Power supply :	12V 3A
Safety :	Emergency stop button <b>present</b>
I/O port :	Digital in 1 Analog out 1
I/O power supply :	5 V / 300mA 1 12 V / 3A 1
Control parameters :	Speed (0-100%) & direction using potentiometer Off position if digital input is positive
Temperature :	The control box can work in a temperature range of 5 - 45°C
Materials :	POM

### IR Sensor

Sensing range :	3-80 cm / 1.18-31.49 In
Sensing object :	Translucency, opaque
Power supply :	DC 5V / 150mA
Output operation :	Normally open (O)
Output :	DC three wire system (NPN)
Cable assignment :	Red +5V Yellow Signal Green GND
Temperature :	The conveyor can work in a temperature range of -25 - 70°C
Snaplink :	Supported
Materials :	ABS

### Magnetic slope

Useful size of ramp :	40 x 230 mm / 1,57 x 9,05 In
Tilt angle :	20°
Snaplink :	Supported
Material :	Aluminum, POM



## Conveyor Technical specifications

### Vision tag

Weight :	82 g / 2,89 oz
Snaplink :	Supported
Material :	Aluminum

### End stopper

Weight :	40 g / 1,41 oz
Mounting interface :	Magnetic
Mounting options :	On both sides of the conveyor

### Color shape

Weight :	Cercle	11 g / 0,38 oz
	Square	13 g / 0,45 oz
Color :	Blue	RAL5010
	Red	RAL3020
	Green	RAL6024
Size :	Cercle	D 38 mm / D 1,49 In
	Square	38 x 38 mm / 1,49 x 1,49 In
Materials :	PEHD	

