

Vacuum pump Technical specifications

Vacuum pump

Weight:	700 g / 24,69 oz
Cable :	60 cm / 23,62 In
Robot compatibility :	Ned 2
Snaplink :	Supported on 2 sides
Mounting option :	Snaplink system Screw (4 x CHC M4 screw)
Payload :	250g*

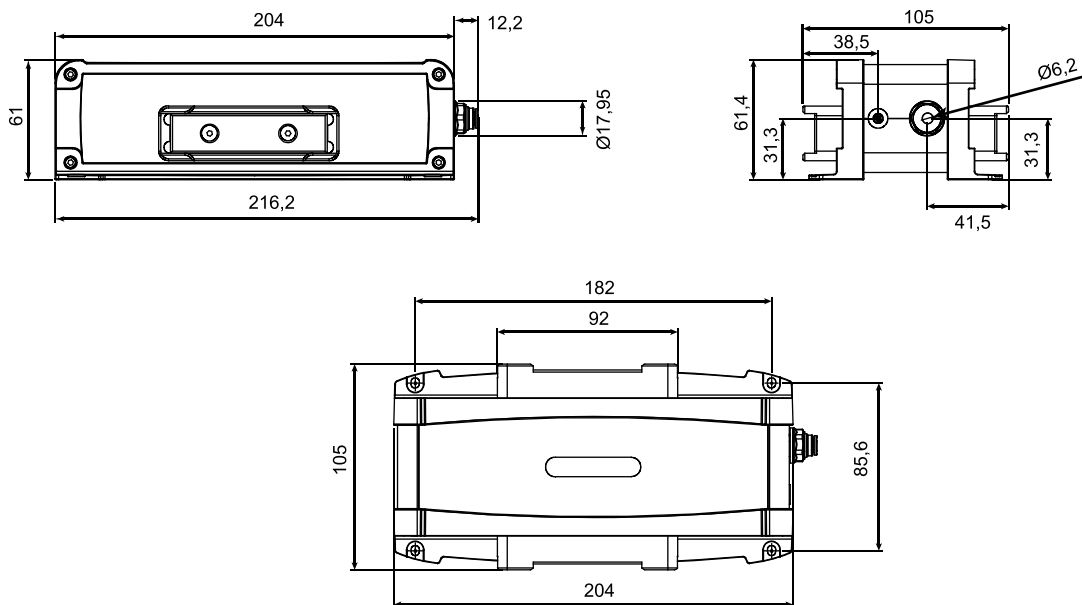

Suction tool

Weight :	19,5 g / 0,67 oz
Mounting robot interface :	Magnetic easy connect
TCP without suction cup :	47 mm / 1,85 In
Suction cup interface :	$\varnothing 6/\varnothing 4$
Pipe interface :	D 6 mm / D 0,23 In



Vacuum pump Technical specifications

Vacuum pipe

Length :	1,5 m / 59 In
Diameter :	OD 6 mm x ID 4 mm
Color :	Black
Hardness :	95 +/- 2A
Working pressure :	1.0 MPa
Limit Elongation :	450%
Tensile Strength :	400 kgf / cm ² - 3922 N / cm ²
Tear Strength :	110 kgf / cm ² - 1078 N / cm ²

Suction cup

	Type 1	Type 2
Diameter :	10 mm	25 mm
Color :	Black	Black
Heigh :	16 mm	23 mm
Materials :	Urethane rubber	Nitrile rubber NBR

*The maximum payload depends on the pipe and suction tool used, and also on the surface area of the part being vacuumed.

The 250g indicated is valid for a smooth surface such as our colour blocks supplied with our products, for a duration of 120s using the pipe and suction cups supplied.

